

e*Tag® - ET8 Access Control Readers

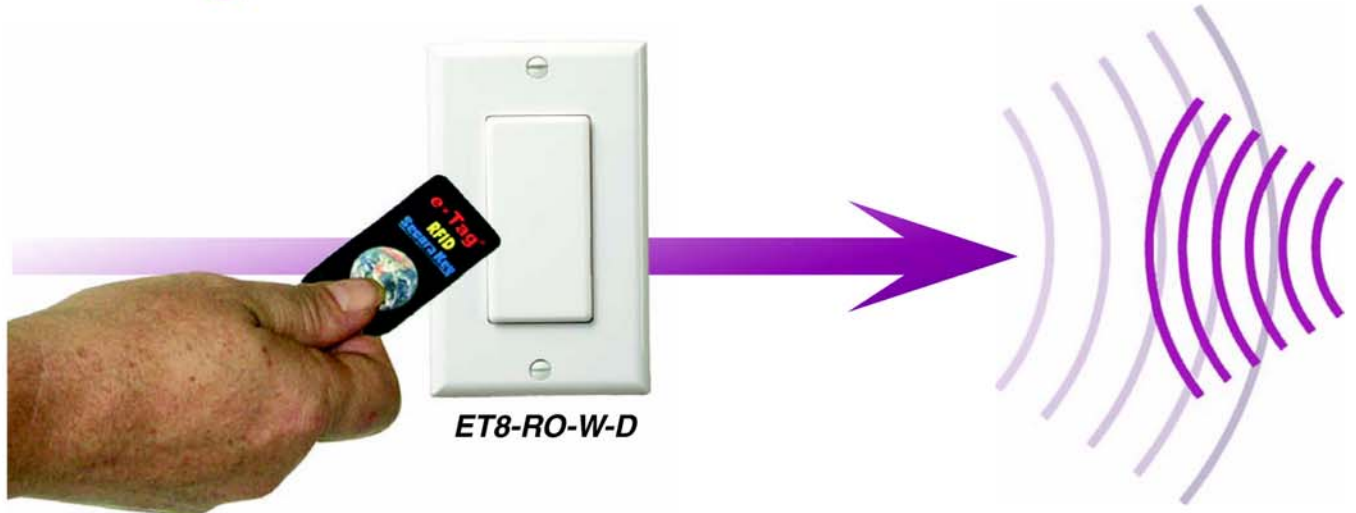

ET8-RO-W-D

Contactless Smartcard Readers

e*Tag® ET8 readers combine leading edge contactless smart card technology with architectural design, easy installation, and simplicity of use. The ET8 reader is compatible with existing e*Tag® readers and cards.

ET8 is available in a weatherproof mullion-mount style, which can be used on standard mullions or doorframes, or in the Decorator style, which is designed for indoor use, fits standard single gang electrical boxes and uses the popular Decora® cover plate.

Like all e*Tag® readers, the ET8 reader uses 13.56 MHz technology and works with Secura Key encoded cards and key tags that meet the ISO 15693 international standard. Secura Key uses enhanced DES encryption which makes e*Tag® cards virtually impossible to counterfeit. Cards are available with custom, 4-color graphics and are ready for dye-sublimation photo ID printing. Unique "Personalized Stock" cards and compact and colorful key tags are also available. e*Tag® credentials have additional



ET8-RO-W-M

memory that can be used for applications such as time-and-attendance, electronic purse and membership/loyalty programs.

e*Tag® ET8 readers have a SIA standard Wiegand output, so they are compatible with the Secura Key SK-ACP-LE and with controllers by most other manufacturers. Standard wire colors and functions allow easy upgrade of existing Wiegand or proximity readers. A convenient wiring harness can be installed during "rough-in" and the reader can simply be plugged in when the job is finished.

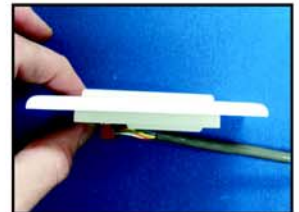

*Decora® is a registered trademark of Leviton, Inc.

FEATURES:

- Compact Design
- 13.56 MHz Contactless Smart Cards
- 4" Read Range
- Multi-Color LED & Buzzer
- Wiegand Output, Compatible With Most Access Control Systems

